

[View this email in your browser](#)

I INNOVATION

ILLUMINATION SYSTEMS

HAPPY THANKSGIVING

We are grateful for your friendship and support
throughout the year,
and wish you and your loved ones a great Thanksgiving

PERFORMANCE IN LIGHTING

Performance in Lighting USA, located in Conyers, GA, is part of an international group of companies headquartered in Verona, Italy.

The group was formed from a number of well-established technical lighting companies from various countries. Performance in Lighting has a wide sales and distribution network operating in over 100 countries worldwide. Production facilities are located in Verona Italy, Bergamo Italy, Goslar Germany, Brussels Belgium, Conyers GA USA. Sales/distribution subsidiaries are located in England, Holland, France, Finland, Spain, Portugal, Australia, Dubai and Japan.

Recognized for its unique professional approach and technical know-how, Performance in Lighting has combined its international experience and technical expertise to become a worldwide leader in its industry. The group offers various lighting solutions worldwide for many applications including interior, exterior, residential, commercial, and sports lighting providing options to satisfy both architectural and engineering

Performance in Lighting USA concentrates on specification grade luminaires designed to provide a vast array of lighting solutions. Our concentration is outdoor products for illuminating commercial spaces from structural facades to parking areas. We strive to meet the demands of today's lighting community offering made in USA products, European designed with clean, contemporary aesthetics along with aggressive price points and fast lead times.

Text Above and Images below from [Performance in Lighting](#)



SMART LIGHTING

The Smart Lighting Company was created to bring a higher standard of lighting to the marketplace. Lighting fixtures used to be simple – A fixture housing, ballast and some lamps. LEDs came on the market and a new generation of lighting was born.

Smart Lighting Company fixtures have been created with over 25 years of fixture design and manufacturing experience behind them. Our goal is to offer the most advanced lighting second to none. Creating and Fine tuning high quality lenses to produce the most light possible while using the least amount of power. Being able to control the lighting to have it do what you want, when you want. Lighting that is ahead of its time and will continue to be without sacrificing quality, using easy connectors to simplify the installation and control of these fixtures. Take any of our fixtures and compare them side by side and you will clearly see the difference between good and the best. - thesmartlightingcompany.com

Text above and images below from Smart Lighting

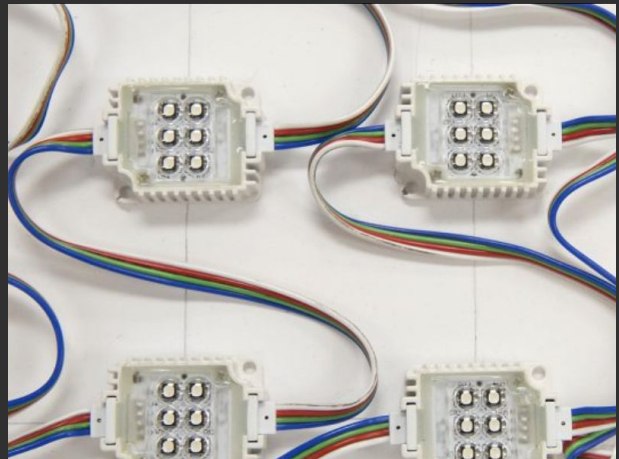

SHAPER SENSE

Shaper Sense is an award winning, industry leading integrated acoustic and lighting product line, that also includes wireless controls options. Lighting is created using an LED edge-lit panel that produces uniform visual distributions. The addition of sound absorbing acoustic panels are designed with industry leading FilzFelt acoustic materials. This provides dual purpose from one point of installation and application. In conjunction, Shaper Sense uses Eaton's award winning Wavelinx and LumaWatt Pro control systems.

The Shaper Sense Box has acoustic panels that are 38mm (1.5") thick, and available in 60+ vibrant and

beautiful colors of 100% Wool Design Felt. In addition, the sound absorbing recycled substrate is made of minimum 60% recycled content and is 100% recyclable. Reverberation is significantly reduced due to

material construction and performance. The Shaper Sense Box allows the designer to select a Top Panel color or Bottom Panel color that allows the designer to compliment their space

The Shaper Sense Trapezoid has acoustic panels that are 38mm (1.5") thick, and available in 60+ vibrant and beautiful colors of 100% Wool Design Felt. In addition, the sound absorbing recycled substrate is made of minimum 60% recycled content and is 100% recyclable. Reverberation is significantly reduced due to material construction and performance. The Shaper Sense Trapezoid allows the designer to select opposing pairs of panels that allows the designer to compliment their space. cooperindustries.com

Text above and images below from Cooper Industries

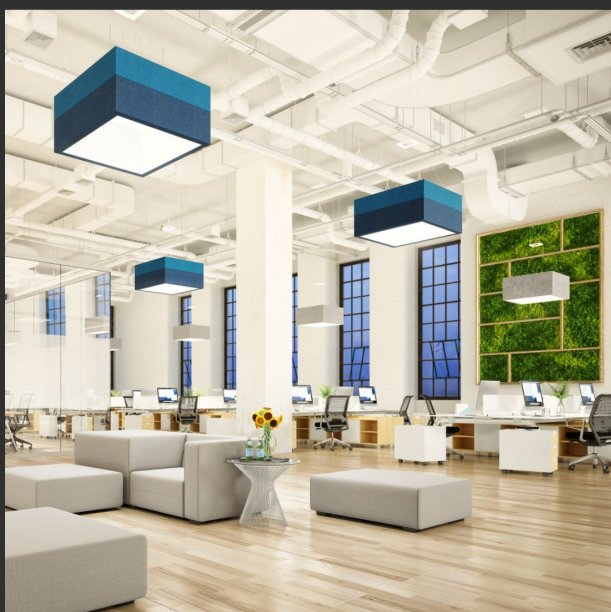

[Visit our website for more information](http://cooperindustries.com)

